

# SERIES 1060 | IN-LINE CIRCULATORS 3D |

## SUBMITTAL

File No: 10.55  
 Date: JANUARY 31, 2022  
 Supersedes: 10.55  
 Date: MARCH 01, 2017

Job: \_\_\_\_\_ Representative: \_\_\_\_\_  
 \_\_\_\_\_ Order no.: \_\_\_\_\_ Date: \_\_\_\_\_  
 Engineer: \_\_\_\_\_ Submitted by: \_\_\_\_\_ Date: \_\_\_\_\_  
 Contractor: \_\_\_\_\_ Approved by: \_\_\_\_\_ Date: \_\_\_\_\_

### PUMP DESIGN DATA

Pump model: \_\_\_\_\_ Flange size: \_\_\_\_\_  
 No. of pumps: \_\_\_\_\_ Note: \_\_\_\_\_  
 Capacity: \_\_\_\_\_ USgpm (L/s) Temperature: \_\_\_\_\_ °F (°C)  
 Head: \_\_\_\_\_ ft (m) Liquid: \_\_\_\_\_  
 Companion flanges: Included  
 All Bronze Circulators are NSF - 372 rated

### MOTOR DESIGN DATA

HP: \_\_\_\_\_ kW: \_\_\_\_\_ RPM: 1750  
 Frame size: \_\_\_\_\_ Enclosure: \_\_\_\_\_  
 Volts: \_\_\_\_\_ Hertz: \_\_\_\_\_ Phase: \_\_\_\_\_

### MATERIALS OF CONSTRUCTION

PART NAME	BRONZE FITTED	LEAD FREE BRONZE
Pump body	Cast iron	Lead free bronze

**Impeller:** Non-ferrous

**Shaft:** Alloy steel-copper sleeve

**Stationary seal face:** ARMSEAL ceramic

**Coupler:** Flexible, spacer type

**Bearings:** Sleeve-oil lubricated

**Seal:** Mechanical

**Motor:** 1800 RPM - rigid mount

SINGLE OR THREE PHASE - 1 and 1-½ HP

THREE PHASE - 2 and 3HP

### MAXIMUM PUMP OPERATING CONDITIONS

175 psig at 225°F (1208 kPa at 107°C)

### OPTIONAL EQUIPMENT

See performance curves on page 3.

**PUMP BODY DIMENSIONS**

PUMP SIZE	MOTOR H.P.	FLANGE SIZE	DIMENSIONS INCHES (mm)					SHIPPING WEIGHT
			L	B	M	D	N	lbs (kg)
3D	1	3	23.05 (597)	18.00 (457)	18.05 (470)	1.00 (25)	-	135 (61)
	1½	3	24.00 (610)	18.00 (457)	19.00 (483)	1.00 (25)	8.88 (225)	138 (63)
	2	3	25.00 (635)	18.00 (457)	20.00 (508)	1.00 (25)	9.88 (251)	143 (65)
	3	3	27.75 (705)	18.00 (457)	22.75 (578)	1.00 (25)	-	150 (68)

**NOTE:**

- Dimensions are for reference only.
- Three phase motors require external overload protection.

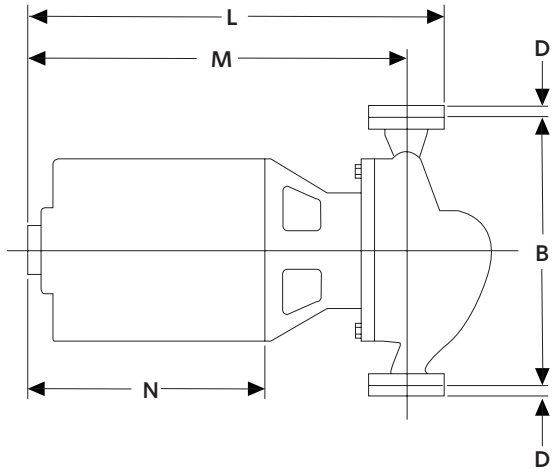

**RIGID MOUNT**

**SERIES 1060 PERFORMANCE CURVES**

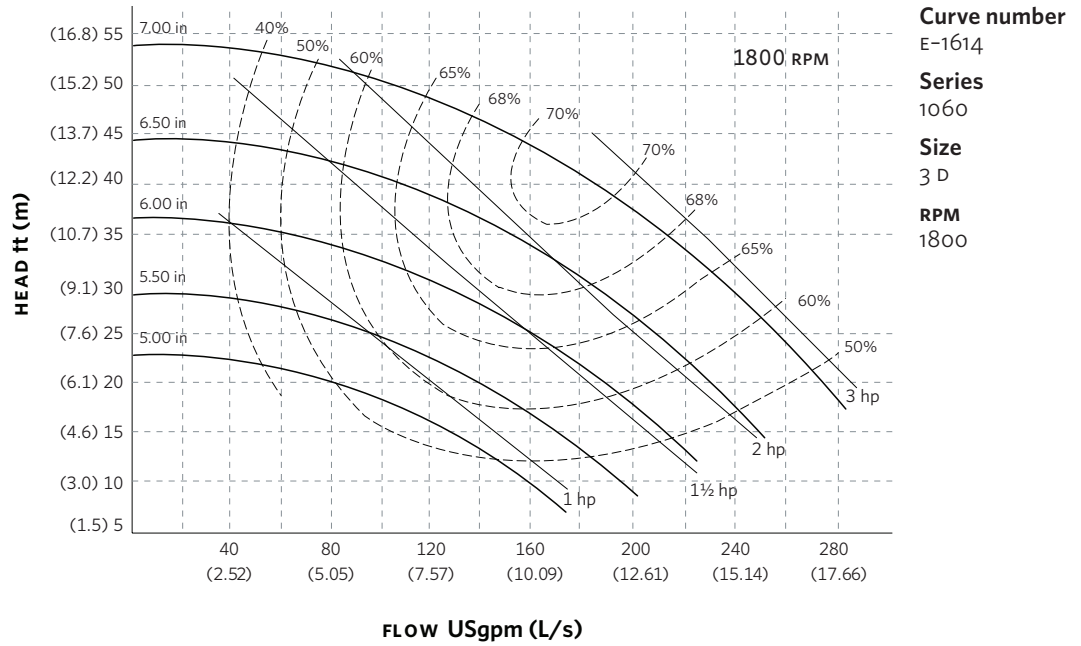

Performance curves are for reference only.  
Confirm current performance data with Armstrong ACE ONLINE selection software.

**TORONTO**

23 BERTRAND AVENUE  
TORONTO, ONTARIO  
CANADA, M1L 2P3  
+1 416 755 2291

**BUFFALO**

93 EAST AVENUE  
NORTH TONAWANDA, NEW YORK  
U.S.A., 14120-6594  
+1 716 693 8813

**DROITWICH SPA**

POINTON WAY,  
STONEBRIDGE CROSS BUSINESS PARK  
DROITWICH SPA, WORCESTERSHIRE  
UNITED KINGDOM, WR9 0LW  
+44 8444 145 145

**MANCHESTER**

WOLVERTON STREET  
MANCHESTER  
UNITED KINGDOM, M11 2ET  
+44 8444 145 145

**BANGALORE**

#59, FIRST FLOOR, 3RD MAIN  
MARGOSA ROAD, MALLESWARAM  
BANGALORE, INDIA, 560 003  
+91 80 4906 3555

**SHANGHAI**

UNIT 903, 888 NORTH SICHUAN RD.  
HONGKOU DISTRICT, SHANGHAI  
CHINA, 200085  
+86 21 5237 0909

**SÃO PAULO**

RUA JOSÉ SEMIÃO RODRIGUES AGOSTINHO,  
1370 GALPÃO 6 EMBU DAS ARTES  
SAO PAULO, BRAZIL  
+55 11 4785 1330

**LYON**

93 RUE DE LA VILLETTE  
LYON, 69003 FRANCE  
+33 4 26 83 78 74

**DUBAI**

JAFZA VIEW 19, OFFICE 402  
P.O.BOX 18226 JAFZA,  
DUBAI - UNITED ARAB EMIRATES  
+971 4 887 6775

**MANNHEIM**

DYNAMOSTRASSE 13  
68165 MANNHEIM  
GERMANY  
+49 621 3999 9858

**JIMBOLIA**

STR CALEA MOTILOR NR. 2C  
JIMBOLIA 305400, JUD.TIMIS  
ROMANIA  
+40 256 360 030

ARMSTRONG FLUID TECHNOLOGY  
ESTABLISHED 1934

ARMSTRONGFLUIDTECHNOLOGY.COM