

Series 4302

4 x 4 x 8

SUBMITTAL

JOB: _____	REPRESENTATIVE: _____
ENGINEER: _____	ORDER NO: _____ DATE: _____
CONTRACTOR: _____	SUBMITTED BY: _____ DATE: _____
	APPROVED BY: _____ DATE: _____

PUMP DESIGN DATA			
NO. OF PUMPS:			
TAG:			
CAPACITY:	(L/s) USgpm	HEAD:	m (ft)
LIQUID:		VISCOSITY:	
TEMPERATURE:		°C (°F)	SPECIFIC GRAVITY:

MOTOR DESIGN DATA			
HP:	RPM:		
FRAME SIZE:	ENCLOSURE:		
VOLTS:	HERTZ: 50 Hz	PHASE:	
EFFICIENCY: <input type="checkbox"/> ENERGY EFFICIENT (EPAct/NRcan) <input type="checkbox"/> NEMA PREMIUM			
FLANGE SIZE:	SUCTION: 4" (100 mm)	DISCHARGE: 4" (100 mm)	

MATERIALS OF CONSTRUCTION		
ANSI FLANGE RATING	<input type="checkbox"/> ANSI 125	<input type="checkbox"/> ANSI 250
CONSTRUCTION	<input type="checkbox"/> BF	<input type="checkbox"/> DBF
CASING	CAST IRON	DUCTILE IRON
IMPELLER	BRONZE	BRONZE
FLUSH LINE	COPPER	COPPER
PUMP SHAFT	416 STAINLESS STEEL	
COUPLING	HIGH TENSILE ALUMINUM	
GASKET	CONFINED NON-ASBESTOS	

MECHANICAL SEAL DESIGN DATA
See File No. 43.50 for standard mechanical seal details as indicated below
Armstrong Seal Reference Number
<input type="checkbox"/> C1 (a) Other _____

SEAL DATA OPTIONS

OPTIONAL EQUIPMENT
SEE FILE NO. 43.50 FOR ENVIRONMENTAL ACCESSORIES

MAXIMUM PUMP OPERATING CONDITIONS	
ANSI 125	ANSI 250
12 bars at 60°C (175 psig at 140°F)	26 bars at 38°C (375 psig at 100°F)
7 bars at 149°C (100 psig at 300°F)	19 bars at 260°C (275 psig at 500°F)
SEE FILE NO. 43.50 FOR MAXIMUM SEAL OPERATING CONDITIONS	

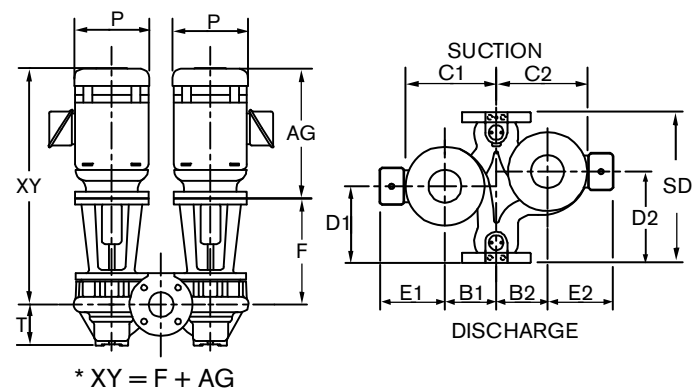

- COUPLING GUARD (NOT SHOWN) IS SUPPLIED.
- FOR EXACT INSTALLATION DATA PLEASE WRITE FACTORY FOR CERTIFIED DIMENSIONS.
- SEE PERFORMANCE CURVES ON PAGE 2.

MOTOR FRAME	HP @ RPM		DIMENSIONS in mm (ins)														WEIGHT in kgs (lbs)	
	3000		P	C1	C2	D1	D2	B1	B2	E1	E2	T	SD	XY	odp	tefc		
145		1500	191(7.50)							152(6.00)	152(6.00)							
182		1000	241(9.50)															
182		1500								178(7.00)	178(7.00)							
184		1000																
213		1500																
213		1000																
254	20	1500	276(10.88)	383	397	369	369	222	222	238(9.38)	238(9.38)							
254	/20	1000	330(13.00)	(15.09)	(15.63)	(14.53)	(14.53)	(8.75)	(8.75)	264(10.38)	264(10.38)	160	702					
254	/20	1500	356(14.00)							286(11.25)	286(11.25)	(6.28)	(27.63)					
256	25	1500	330(13.00)							264(10.38)	264(10.38)							
256	/25	1000	356(14.00)							286(11.25)	286(11.25)							
284	30	1500	330(13.00)							289(11.38)	289(11.38)							
284	/30	1000	356(14.00)							302(11.88)	302(11.88)							
286	40	1500	330(13.00)							289(11.38)	289(11.38)							
286	/40	1000	387(15.25)							333(13.13)	333(13.13)							



PERFORMANCE CURVES

Performance Guaranteed Only At Operating Point Indicated

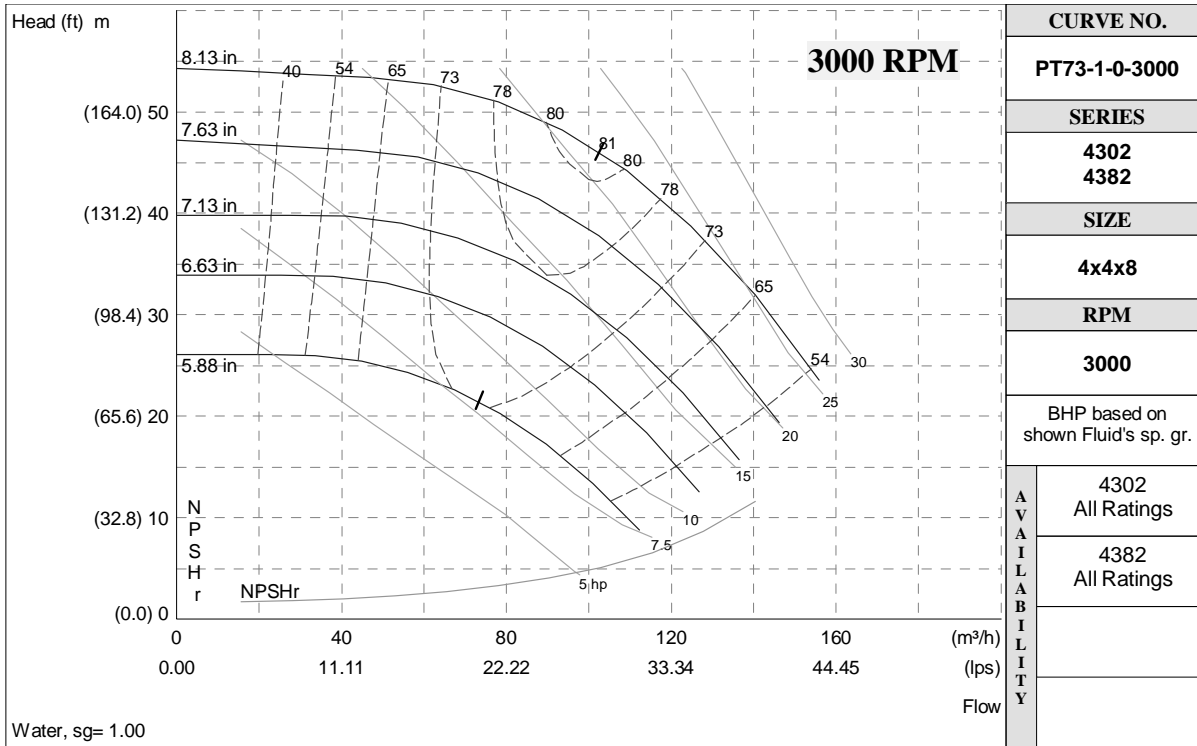

CURVE NO.	PT73-1-0-3000
SERIES	4302 4382
SIZE	4x4x8
RPM	3000
BHP based on shown Fluid's sp. gr.	
A V A I L A B I L I T Y	4302 All Ratings
	4382 All Ratings

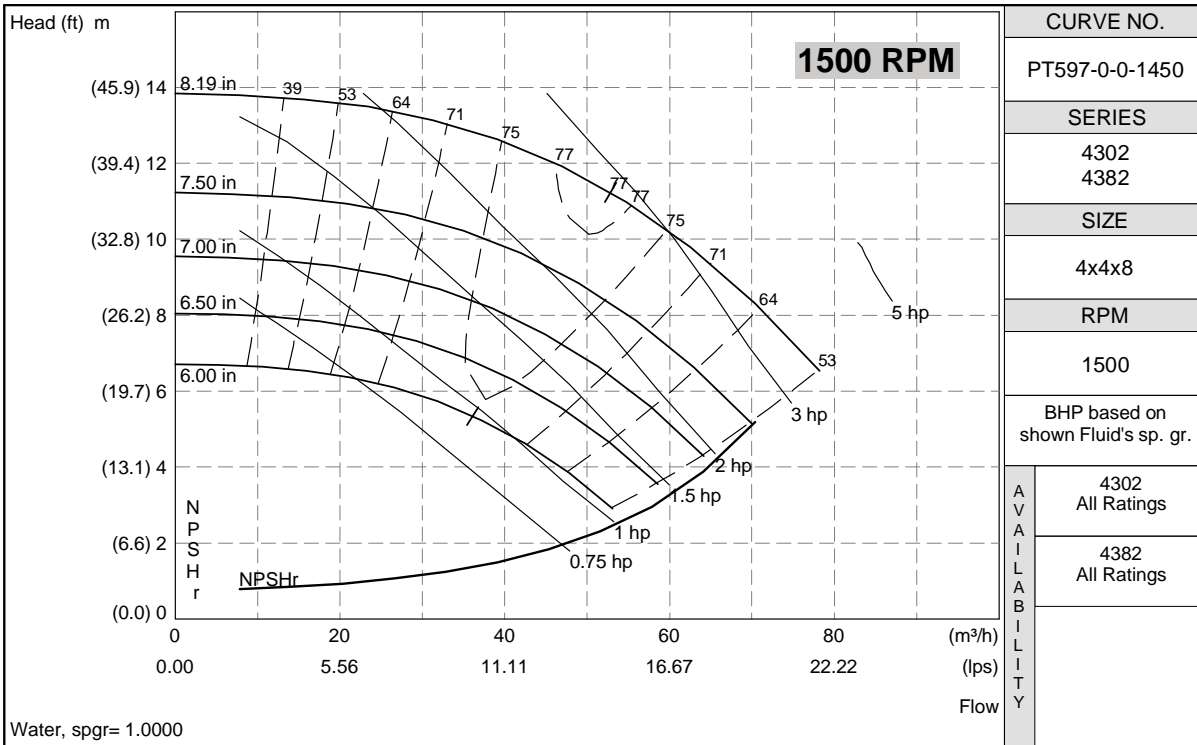

CURVE NO.	PT597-0-0-1450
SERIES	4302 4382
SIZE	4x4x8
RPM	1500
BHP based on shown Fluid's sp. gr.	
A V A I L A B I L I T Y	4302 All Ratings
	4382 All Ratings

S. A. Armstrong Limited
 23 Bertrand Avenue
 Toronto, Ontario
 Canada, M1L 2P3
 T: (416) 755-2291
 F (Main): (416) 759-9101

Armstrong Pumps Inc.
 93 East Avenue
 North Tonawanda, New York
 U.S.A. 14120-6594
 T: (716) 693-8813
 F: (716) 693-8970

Armstrong Holden Brooke Pullen
 Wenlock Way
 Manchester
 United Kingdom, M12 5JL
 T: +44 (0) 161 223 2223
 F: +44 (0) 161 220 9660



© S.A. Armstrong Limited 2009

For Armstrong locations worldwide, please visit www.armstrongintegrated.com