

Series 4600 Horizontal Split Case Pump

200-450

SUBMITTAL

JOB: _____ REPRESENTATIVE: _____

ENGINEER: _____ ORDER NO: _____ DATE: _____

CONTRACTOR: _____ SUBMITTED BY: _____ DATE: _____

APPROVED BY: _____ DATE: _____

PUMP DESIGN DATA			
NO. OF PUMPS:	TAG:		
CAPACITY:	m ³ /hr (L/s)	HEAD:	m (ft)
LIQUID:	VISCOSITY:		
TEMPERATURE:	°C(°F)	SPECIFIC GRAVITY:	

MOTOR DESIGN DATA			
KW:	RPM:		
FRAME SIZE:	ENCLOSURE:		
VOLTS:	HERTZ: 50 Hz	PHASE:	
EFFICIENCY:	<input type="checkbox"/> EFF 2	<input type="checkbox"/> EFF1	<input type="checkbox"/> Other _____
FLANGE SIZE:	Suction : 300mm (12")	Discharge: 200mm (8")	

MATERIALS OF CONSTRUCTION		
FLANGE RATING	<input type="checkbox"/> PN16	<input type="checkbox"/> PN25
CONSTRUCTION	BF	250 BF
CASING	CAST IRON	
IMPELLER	BRONZE	
FLUSH LINE	COPPER	STEEL
WEAR RINGS	BRONZE	
SHAFT	CARBON STEEL	
SHAFT SLEEVE	BRONZE	
GASKET	VELOTHERM (FIBER)	

OPTIONAL EQUIPMENT

MAX. PUMP OPERATING CONDITIONS	12 bars at 60°C (175 psi at 140°F)	21 bars at 66°C (300 psi at 150°F)
	10 bars at 121°C (140 psi at 250°F)	17 bars at 121°C (250 psi at 250°F)

SUCTION SIDE REQUIREMENT	
IMPORTANT (PLEASE SELECT)	(Viewed from motor end)
	<input type="checkbox"/> RIGHT HAND (ILLUSTRATED)
	<input type="checkbox"/> LEFT HAND

MECHANICAL SEAL DESIGN DATA		
SEAL TYPE	A21	ARO
STATIONARY SEAT	SILICON CARBIDE	CARBON
ROTATING FACE	CARBON	DURCHROME
SECONDARY SEAL	EPDM	VITON
SPRING	STAINLESS STEEL	
ROTATING HARDWARE	STAINLESS STEEL	
GLAND PLATE	BRONZE	

- TOLERANCE OF ±0.125" (±3 mm) SHOULD BE USED
- FOR EXACT INSTALLATION DATA PLEASE WRITE FACTORY FOR CERTIFIED DIMENSIONS

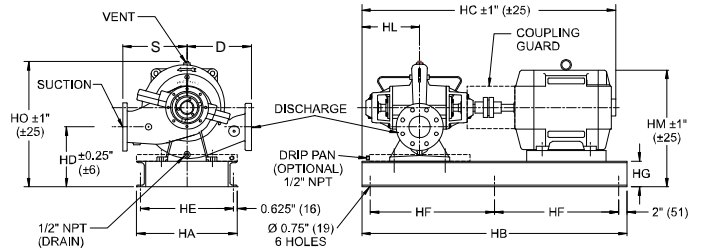

MOTOR FRAME	kW @ rpm			DIMENSIONS mm (inches)												WEIGHT kg (lbs.)				
	1500		1000	HA	HB	HC (max)	HD	HE	HF	HG	HL	HM	HO	S	D	ODP	TEFC			
	ODP	TEFC																		
200L	--	--	22	813 (32.00)	2032 (80.00)	1773(69.79)	445 (17.50)	737 (29.00)	965 (38.00)	152 (6.00)	491 (19.35)	1143 (45.00)	533 (21.00)	457 (18.00)	1380.3(3043)	1475.6(3253)				
225M	--	--	30			1830(72.04)											1219 (48.00)	984(38.75)	1609.4(3548)	1768.1(3898)
250M	--	--	37			2540 (100.00)												1941(76.41)		
280S	--	--	45		2476(97.48)				1632.1(3598)								1813.5(3998)			
280M	90	--	55		1632.1(3598)													1813.5(3998)		
315	110-185	90-185	--																	



PERFORMANCE CURVES

Performance Guaranteed Only At Operating Point Indicated
 CURVE SHOWN FOR CLEAR, COLD WATER - SP. GR. 1.0

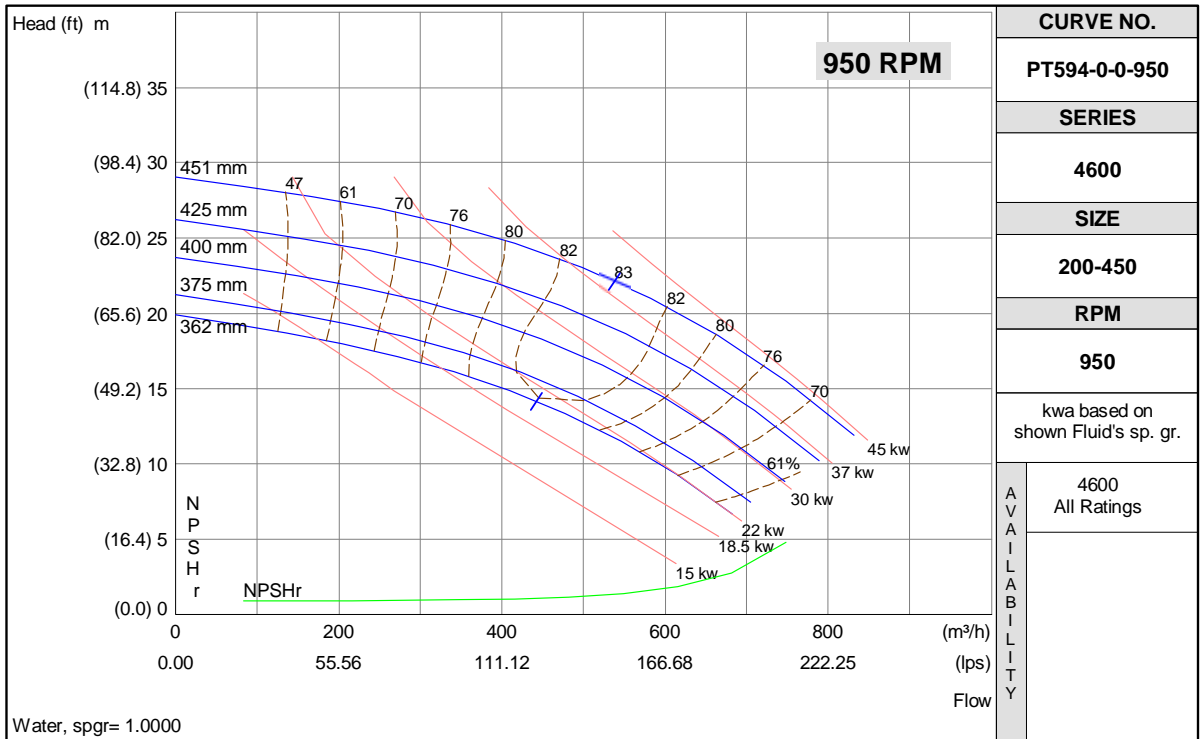
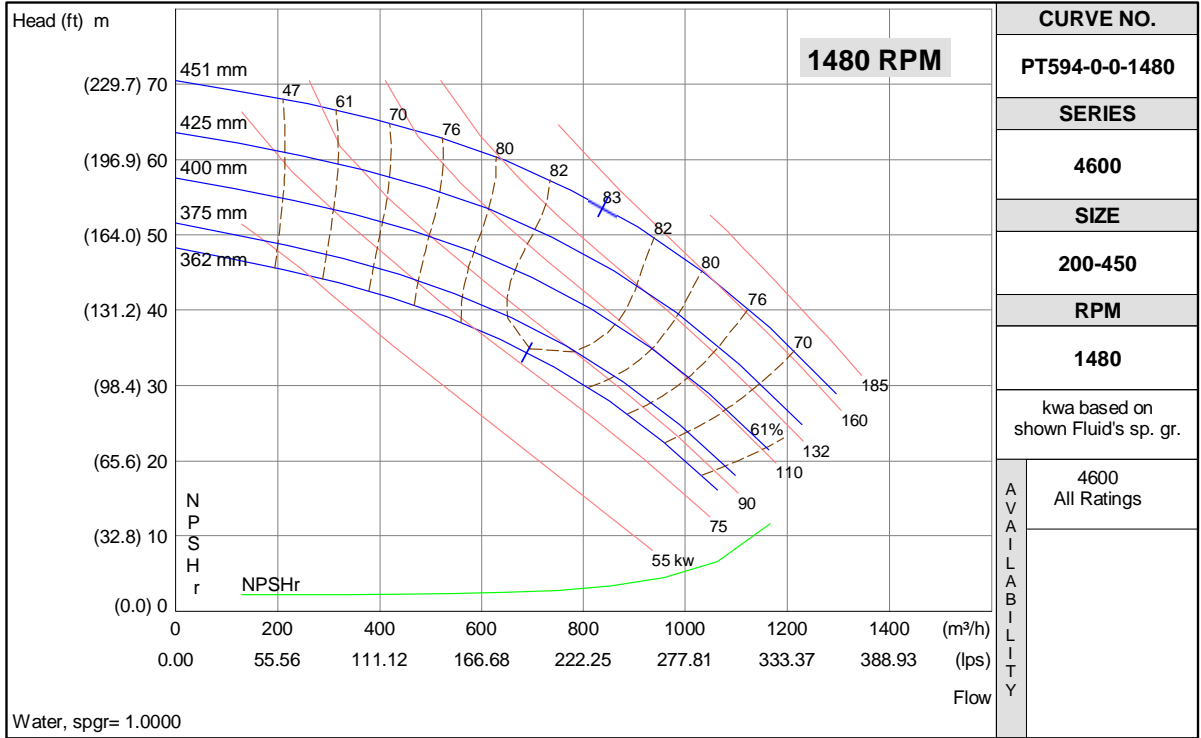

S. A. Armstrong Limited
 23 Bertrand Avenue
 Toronto, Ontario
 Canada, M1L 2P3
 T: (416) 755-2291
 F (Main): (416) 759-9101

Armstrong Pumps Inc.
 93 East Avenue
 North Tonawanda, New York
 U.S.A. 14120-6594
 T: (716) 693-8813
 F: (716) 693-8970

Armstrong Holden Brooke Pullen Ltd.
 Wenlock Way
 Manchester
 United Kingdom, M12 5JL
 T: +44 (0) 161 223 2223
 F: +44 (0) 161 220 9660



© S.A. Armstrong Limited 2010

For Armstrong locations worldwide, please visit www.armstrongintegrated.com