

AET SERIES | EXPANSION TANKS (ASME) |

AET 12×33 TO AET 42×96 | SUBMITTAL

File No: 37-55
Date: APRIL 05, 2022
Supersedes: 37-53
Date: OCTOBER 19, 2015

Job: _____ Representative: _____
_____ Order no.: _____ Date: _____
Engineer: _____ Submitted by: _____ Date: _____
Contractor: _____ Approved by: _____ Date: _____

DATA

Model no. ordered: _____ Qty: _____
Tag no.: _____ Charge pressure: _____ psi/kPa
Optional saddles required: Yes No
Finish: Painted Galvanized
Standard factory charge is 40 psi (276 kPa) unless otherwise specified.

MAXIMUM OPERATING CONDITIONS

Working temperature: -20°F to 450°F (-29°C to 232°C)

Working pressure

- AET 12×33 - AET 20×78: 150 psi (1034 kPa)
- AET 24×65 - AET 42×96: 125 psi (862 kPa)

NOTES

- Not for domestic potable water systems.
- Designed and constructed per asme section viii, division 1.
- Gauge tapping included(gauge & fittings by others)

MATERIALS OF CONSTRUCTION

Shell: Carbon steel
Head: Carbon steel

TYPICAL SPECIFICATION

Furnish and install, as shown on the plans, a _____ gal.(L), _____ dia. x _____ long Armstrong Model AET plain steel expansion tank. The tank, shall have NPT system connection, glass gauge tappings and drain. Tank shall be furnished with a base ring for vertical storage or optional saddles for horizontal mount (see note #3). The tank shall be constructed and stamped in accordance with section viii of the ASME boiler & pressure vessel code.

MODEL	TANK VOLUME	A	B	C	D	E	F	G	APPROX. SHIPPING WEIGHT			
	gal.(L)							inches (mm)				
											lbs.(kg)	
AET 12x33	15 (57)	12.00 (305)	33.00 (838)	8.00 (203)	7.00 (178)	11.50 (292)	0.88 (22)	1.00 (25)	44 (20)	49 (22)		
AET 12x51	24 (91)	12.00 (305)	51.00 (1295)	8.00 (203)	7.00 (178)	11.50 (292)	0.88 (22)	1.00 (25)	62 (28)	69 (31)		
AET 14x48	30 (114)	14.00 (356)	48.00 (1219)	10.00 (254)	10.00 (254)	11.50 (292)	1.13 (29)	1.00 (25)	72 (33)	80 (36)		
AET 14x63	40 (151)	14.00 (356)	63.00 (1600)	10.00 (254)	10.00 (254)	11.50 (292)	1.13 (29)	1.00 (25)	92 (42)	102 (46)		
AET 16x72	60 (227)	16.00 (406)	72.00 (1829)	12.00 (305)	10.00 (254)	11.50 (292)	1.13 (29)	1.00 (25)	120 (55)	134 (61)		
AET 20x62	80 (303)	20.00 (508)	62.00 (1575)	16.00 (406)	10.00 (254)	18.00 (457)	1.50 (38)	1.00 (25)	136 (62)	151 (69)		
AET 20x78	100 (379)	20.00 (508)	78.00 (1981)	16.00 (406)	10.00 (254)	18.00 (457)	1.50 (38)	1.00 (25)	168 (76)	187 (85)		
AET 24x65	120 (454)	24.00 (610)	65.00 (1651)	20.00 (508)	11.13 (283)	18.00 (457)	1.50 (38)	1.00 (25)	218 (99)	238 (108)		
AET 24x72	135 (511)	24.00 (610)	72.00 (1829)	20.00 (508)	11.13 (283)	18.00 (457)	1.50 (38)	1.00 (25)	238 (108)	258 (117)		
AET 30x62	175 (662)	30.00 (762)	62.00 (1575)	22.00 (559)	13.50 (343)	24.00 (610)	2.00 (51)	1.50 (38)	338 (154)	361 (164)		
AET 30x77	220 (833)	30.00 (762)	77.00 (1956)	22.00 (559)	13.50 (343)	24.00 (610)	2.00 (51)	1.50 (38)	368 (167)	396 (180)		
AET 30x84	240 (908)	30.00 (762)	84.00 (2134)	22.00 (559)	13.50 (343)	24.00 (610)	2.00 (51)	1.50 (38)	394 (179)	424 (193)		
AET 30x105	305 (1154)	30.00 (762)	105.75 (2686)	22.00 (559)	13.50 (343)	24.00 (610)	2.00 (51)	1.50 (38)	486 (221)	523 (238)		
AET 36x72	295 (1117)	36.00 (914)	72.00 (1829)	28.00 (711)	14.75 (375)	30.00 (762)	2.50 (64)	1.50 (38)	502 (228)	540 (245)		
AET 36x93	400 (1514)	36.00 (914)	91.50 (2324)	28.00 (711)	14.75 (375)	30.00 (762)	2.50 (64)	1.50 (38)	645 (293)	686 (312)		
AET 36x120*	505 (1911)	36.00 (914)	120.00 (3048)	28.00 (711)	14.75 (375)	-	-	1.50 (38)	810 (368)	844 (384)		
AET 42x96*	525 (1987)	42.00 (1067)	96.00 (2438)	28.00 (711)	18.00 (457)	-	-	2.00 (51)	895 (406)	928 (422)		

TORONTO

+1 416 755 2291

BUFFALO

+1 716 693 8813

DROITWICH SPA

+44 8444 145 145

MANCHESTER

+44 8444 145 145

BANGALORE

+91 80 4906 3555

SHANGHAI

+86 21 5237 0909

SÃO PAULO

+55 11 4785 1330

LYON

+33 4 26 83 78 74

DUBAI

+971 4 887 6775

MANNHEIM

+49 621 3999 9858

JIMBOLIA

+40 256 360 030

NOTES

- Plugged inspection openings (qty 2 - 2.0" each) are provided on 175 to 505 gallon tanks (662 L to 1911 L respectively).
- An inspection Manhole is furnished on the 525 gal. (1987 L) tank. Manhole dimensions are 12" x 16" (305 mm x 406 mm).
- Stand Ring are not provided on AET 36x120 and AET 42x96

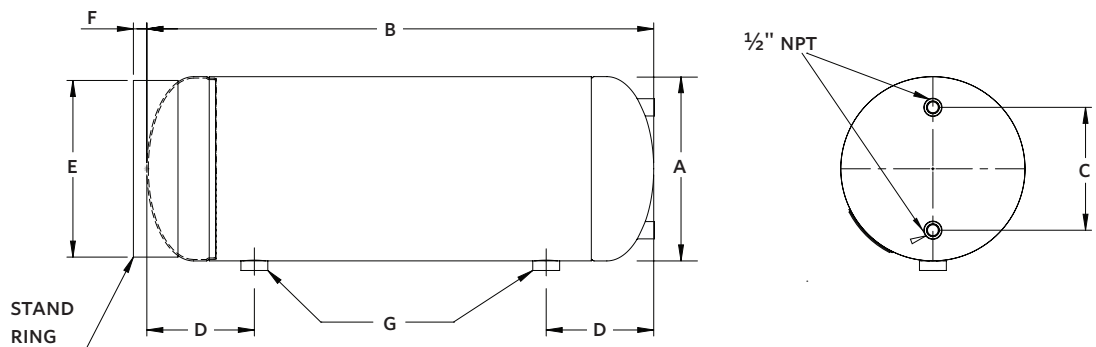

MODELS AET 12x33 TO AET 42x96